

Washer Quick Start Guide

We know you're excited about owning an ASKO washing machine and you're anxious to get started, so here is a brief summary of the operating procedures. To get the most of the features of your machine, we recommend that you read your *Use and Care Guide*.

THE CONTROL PANEL

Models W660 and W640 have ASKO's state-of-the-art EasyControl™ panel, as illustrated below. To select a wash program, simply press one of the preset program buttons then press Start. Refer to "Preset Programs" below for a definition of these programs.

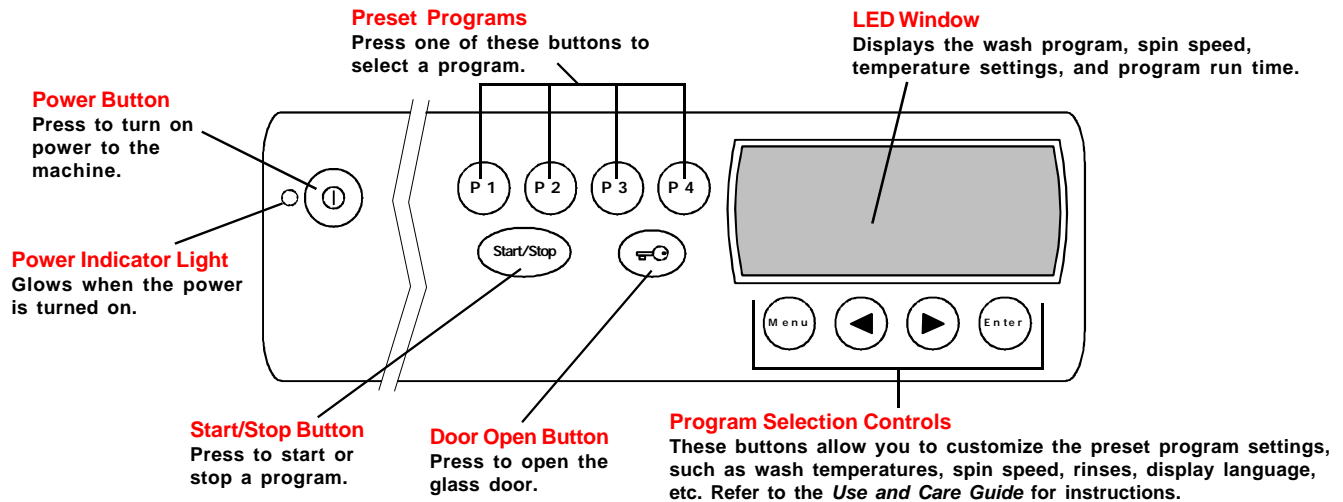

Power Button

 The Power button turns the power to the machine on and off. When the power is on, the power indicator light glows red. The power must be on before you can open the glass door, set the programs or start the machine.

Start/Stop Button

 This button starts or stops a program. To stop a program, press and hold this button for a few seconds. If you stop a program using the Start/Stop button, you will have to reselect a program and press Start/Stop to restart the machine.

Door Open Button

 The power must be on and you must press this button to open the glass door. There will be a few seconds delay before the door opens. If you need to open the door during a wash or rinse cycle, press and hold Door Open for a few seconds. The machine will stop and automatically drain enough water so the door can be opened safely. The program will resume when you close the door. For instructions on how to open the door manually in case of power failure, refer to your *Use and Care Guide*.

Preset Programs

This model has four preset programs, as defined in the table below. To select a program, simply press one of the program buttons and press Start.

Preset Program	Wash Cycle	Types of Laundry	Wash Temp ⁽¹⁾	Spin Speed ^{(1) (2)}	# of Rinses	Short Spin	Long Spin
P1	Normal	White cotton	140° F	1600 rpm ⁽³⁾	5	2	yes
P2	Normal	Normal/Perm Press	105° F	1600 rpm ⁽³⁾	5	2	yes
P3	Super Quick	Lightly soiled fabrics	105° F	1600 rpm ⁽³⁾	2	0	yes
P4	Wool/Hand	Washable wool, silk, nylon	85° F	800 rpm	3	1	no

NOTES: ⁽¹⁾ You can temporarily adjust the temperature settings and spin speed. (See "Temporary Program Changes" below.)

⁽²⁾ These are the maximum spin speed settings allowed for the program (except Super Quick).

⁽³⁾ Model W640 has a maximum spin speed of 1400 rpm.

You can easily customize the preset programs to best fit your laundry needs. See "Customizing the Preset Programs" in your *Use and Care Guide*.

Temporary Program Changes

You can make temporary changes to the wash temperature and/or spin speed on the preset programs. Simply press the button for the preset program you want to use then follow the instructions below. The settings will revert to normal at the end of the program.

Temperature – Press  until the desired temperature displays in the LED window. If you also want to change the spin speed, read the following paragraph, otherwise, press Start.

Spin Speed – Press  until the desired spin speed displays in the LED window then press Start.

QUICK START PROCEDURES

W640/W660

1. Press the Power button to turn on the machine.
2. Press the Door Open button  to open the inner door and load the wash. (The door will open in a few seconds.)
3. Check that the door is clear of laundry then close it firmly. (The door won't shut if it's slammed.)
4. Pour the detergent and fabric softener into the proper compartments in the detergent drawer, as illustrated below. (Don't put detergent in the prewash compartment unless you plan to prewash.)
5. Close the detergent drawer securely. (Do not slam it closed.)
6. Press the button for the desired program. If desired, change the temperature and/or spin speed.
7. Press Start. The machine will start.

UNDERSTANDING THE LED WINDOW

The LED window is easy to read and understand. It displays the wash program selection along with the wash temperature, spin speed, and program run time. The illustration below explains what each item on the LED window is.

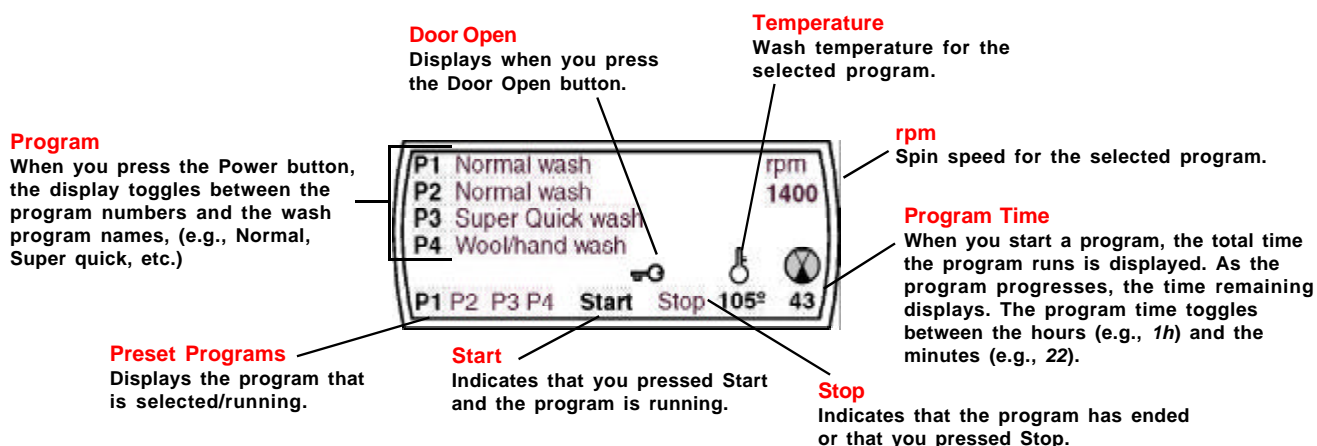

THE DETERGENT DRAWER

The detergent drawer on ASKO washers automatically dispenses the detergent and fabric softener at the appropriate times. The drawer is located to the left of the control panel. Simply pull the drawer out and pour the measured amounts of detergent and softener into the proper compartments (as illustrated) and close the drawer.

NOTE: We recommend that you don't use bleach in your ASKO washer. The tumbling wash action, temperature control options and extended wash times are sufficient to remove most stains.

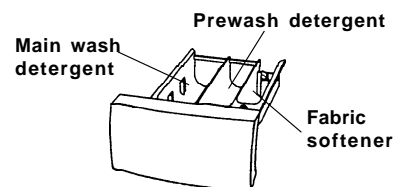

The detergent drawer is equipped with an optional child safety catch. (See your *Use and Care Guide*.)

DETERGENT AND FABRIC SOFTENER AMOUNTS

Because ASKO washers use less water than conventional top-loading washers, you need less detergent and fabric softener. We recommend that you use a low-sudsing *powder* detergent only, preferably a high-efficiency (HE) detergent designed specifically for front-loading washers. (Liquid detergents tend to suds more, which make them more difficult to rinse out.)

Detergent – The amount of detergent needed varies, depending on the detergent you use. For high-efficiency detergent specifically for front-loading washers, you should use the amounts recommended by the manufacturer. For regular laundry detergent, **1 to 3 tablespoons of detergent is all you need for a normal wash load**. More heavily soiled items, however, may need slightly more detergent. Also, the amount of detergent needed can vary due to differences in water hardness. (Refer to your *Use and Care Guide* for more details.) If you choose to use a liquid detergent, start out with a very small amount, such as one or two tablespoons.

Fabric Softener – We recommend that you use only 2 tablespoons of fabric softener. If more softening is desired, try using slightly more with the next load.

Refer to your *Use and Care Guide* for additional programming and operational information as well as care and cleaning instructions.

Art. no. 80 637 68 Rev 02