

Telco, Network & Media Server Systems

Spare parts for Sun Netra t1100/t1120/t1125 Telco Servers

Description	Order Number	Stocking Level		
		5	10	25
System Boards and Modules				
0MB SYSTEM BOARD QUARK	#501-3139	1	2	6
MOTHERBOARD, ULTRA 60	#501-4450	1	2	6
Module 300MHZ UltraSPARC II	#501-4849	1	2	6
440MHz UltraSPARC-II/4MB each	#501-5682	1	2	6
Memory and Mass Storage				
MEMORY,DSIMM,64MB,60NS,S10/S20	#501-2480	1	1	3
S4 0MB 110MHZ CPU BOARD	#501-3134	1	1	3
MEM,DSIMM,32MB,60NS,S20,S10	#501-2622	1	1	3
128MB DIMM, 60NS, ULTRA2	#501-3136	1	1	3
4.2GB 7200RPM Disk Drive Assy	#540-2938	1	1	3
9.1GB 7200RPM Disk Drive Assy	#540-3704	1	1	3
18.2GB 7200RPM Dsk Dr FRU Assy	#540-3719	1	1	3
12X CD-ROM LIGHT GREY	#370-2816	1	1	3
9GB Disk Dr,Fujitsu MAB3091SC	#370-3413	1	1	3
DATA CART DDS3	#370-2378	1	1	3
12/24GB 4mm DDS3 TAPE DRIVE	#370-2377	1	1	3
CDROM, 32X, SERVER MEDIUM GREY	#370-3416	1	1	3
32X CD-ROM Drive, 1.6IN HEIGHT	#370-3415	1	1	3
FRU,Int Disk 18.2GB/10k USCSI	#540-4177	1	1	3
Chassis, Cables and Accessories				
ASSY,LED,PCB/CABLE,NETRA	#540-3605	1	1	1
ASSY, FAN, DC12V, TS-1100	#540-3514	1	1	1
PWR,SUPPLY,DC,350W,I/P-48V,LW	#300-1355	1	1	1
BOARD, ALARMS CARD, TS-91	#501-4669	1	2	3
ASSY,LED,PCB/CABLE,NETRA	#540-3605	1	1	1
CABLE, POWER SWITCH, TS-1100	#530-2514	1	1	1
CABLE, SCSI, T-1100	#530-2473	1	1	1
FAN,FILTER,30PPI,NETRA-T1100	#250-1392	1	2	3
5-1/4 IN DEV EXT FILLER PANEL	#330-2186	1	1	1
3-1/2in DEV EXT FILLER PANEL	#330-2187	1	1	1
10/100 BASE-T CABLE,RJ45-RJ45	#530-1871	1	1	1
PERIPHERAL DC WIRE HARNESS	#530-2345	1	2	3
BRKT,SUPPORT,2*PULSAR,LW2	#540-3809	1	2	3
BOARD, ALARMS CARD, TS-91	#501-4669	1	2	3
CABLE, POWER SWITCH, TS-1100	#530-2514	1	2	3
PWR,SUPPLY,AC,325W,LW	#300-1406	1	2	3
ASSY,LED,PCB/CABLE,NETRA	#540-3605	1	2	3
FRU,PWR,SUPPLY,DC,LW	#300-1462	1	2	3
CABLE,ASSY,SCSI,LSP	#530-2684	1	1	1
PWR,SUPPLY,AC,325W,LW	#300-1406	1	1	1
CABLE,ASSY,SCSI,LSP	#530-2684	1	1	1
32X CD-ROM Drive, 1.6IN HEIGHT	#370-3415	1	1	1

Spare parts for Netra ft 1800

Configuration Overview 16 Slot PCI Logic Enclosure

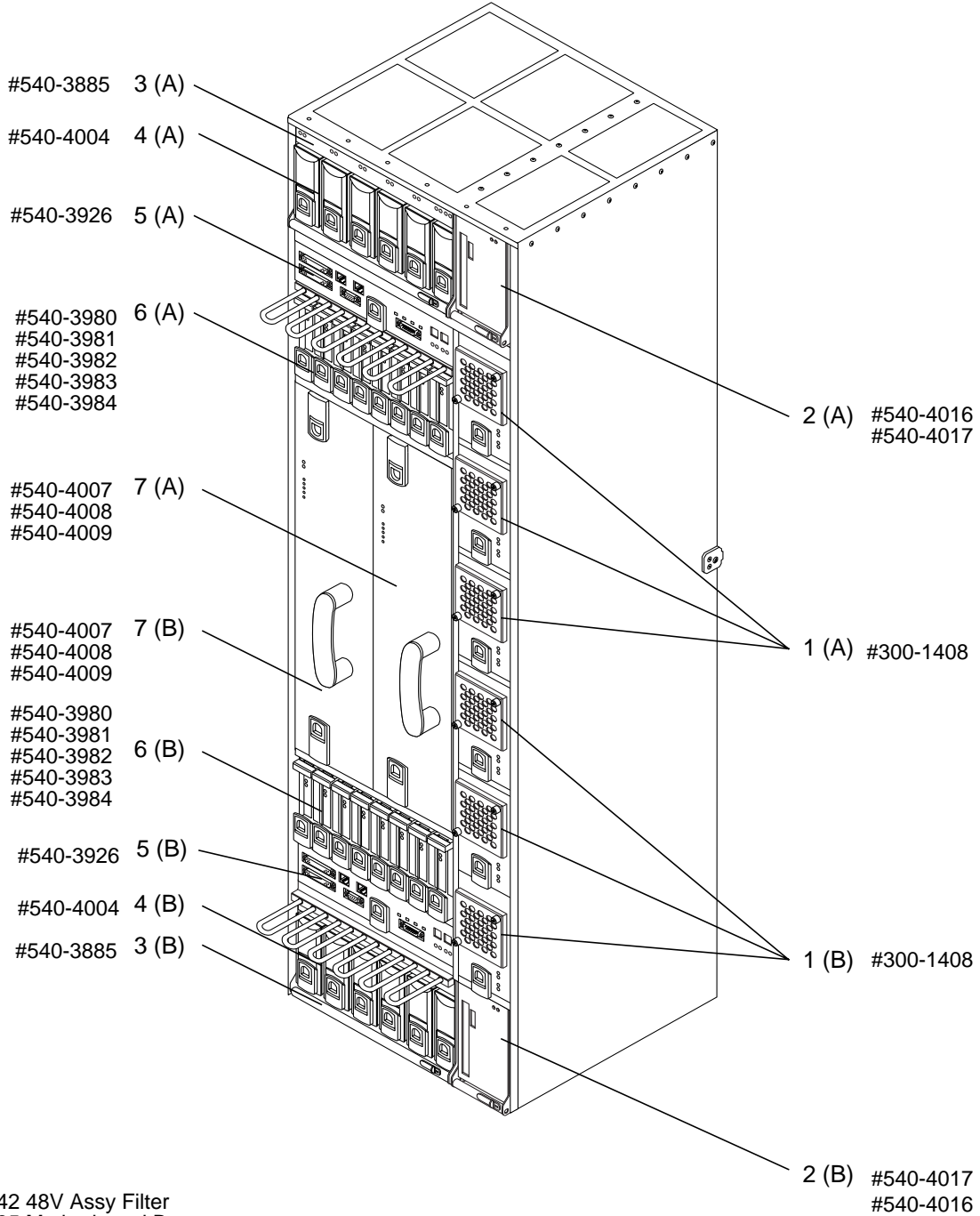

Note: (A) indicates Side A and (B) indicates Side B of the fault tolerant system.

Spare parts for Netra ft 1800 (continued)

Description	Order Number	Stocking Level		
		5	10	25
System Boards and Modules				
MOTHERBOARD B,Netra Ft1800	#540-3485	1	2	6
6927A Disk Drive Chassis Tray				
Disk Drive Chassis Tray	#540-3885	1	2	6
6960A CPUset with 1 x 300MHz UltraSPARC-II processor, 256MB Memory				
CPU,USparcII 1P,256MB,300MHZ	#540-4007	1	2	6
6961A CPUset with 2 x 300MHz UltraSPARC-II processors, 512MB Memory				
CPU USparII,2P,512MBMEM,300Mhz	#540-4008	1	2	6
6962A CPUset with 1 x 300MHz UltraSPARC-II processor, 1GB Memory				
FRU,ASSY,CPU,1P,1GB,300MHZ	#540-4336	1	1	1
6965A CPUset with 4 x 300MHz UltraSPARC-II processors, 4GB Memory				
CPU USparcII,4P,4GB MEM,300MHZ	#540-4009	1	2	6
MOTHERBOARD A, Netra Ft 1800	#540-3509	1	2	6
Memory and Mass Storage				
6930A Removable Media Module Tray with CDROM and DAT Tape				
Assy,RMM TRAY +DAT Tape +CDROM	#540-4016	1	1	3
6929A Removable Media Module enclosure with power converter				
RMM TRAY + CDROM + FRONT PANEL	#540-4017	1	1	3
6956A 9GB disk drive assembly with 'Chip' bracket for ESD sheilding				
9GB HARD DRIVE +CHIP BRACKET	#540-4004	1	1	3
6957A 18GB disk drive assembly with 'Chip' bracket for ESD sheilding				
FRU, ASSY, 18GB, USCSI, W/CHIP	#540-4077	1	1	3
Power Supply				
6923A -48vdc/60vdc 737 watt power supply				
Power Supply-48vdc- +CABLE KIT	#300-1408	1	1	1
ASSY,-48V,INLET,FILTER	#370-3842	1	1	1
FRU,ASSY,EJECTOR,CPU,FT1800	#540-4353	1	1	1
FRU,ASSY,EJECTOR,SMALL,ft1800	#540-3497	1	1	1
FRU,ASSY,EJECTOR,CAF,ft1800	#540-4300	1	1	1
FRU,ASSY,EJECTOR,PCI, ft1800	#540-4301	1	1	1
6924A Power supply blanking module No FRU				

Spare parts for Netra ft 1800 (continued)

Description	Order Number	Stocking Level		
		5	10	25
PCI Options				
6935A PCI carrier with dual-channel differential with Ultra-SCSI host adapter				
PCI/DUAL CHANL SCSI FOR FT1800	#540-3980	1	1	1
6934A PCI carrier with 10/100 BaseT				
PCI/10/100BASET FSTENET FT1800	#540-3981	1	1	1
6931A PCI card carrier with X.25 card				
PCI/HSI for FT1800	#540-3982	1	2	3
6933A PCI carrier with ASYNC card				
PCI/ASYNC SAI FOR FT1800	#540-3983	1	1	1
6932A PCI carrier with ATM 255 card				
PCI/ATM155 for FT1800	#540-3984	1	1	1
6921A Console, Alarm and Fan Module				
Console,Alarm,Fan Module	#540-3926	1	1	1
6843A PCI/Quad fast ethernet PCI card				
FRU,ASSY,PCI,QFE,W/CARRIER	#540-4094	1	1	1
Console,Alarm,Fan Module	#540-3926	1	1	1
ASSY,-48V,INLET,FILTER	#370-3842	1	1	1
6958A Disk drive blanking module No FRU				
6936A PCI slot blanking panel No FRU				
X6936A PCI slot blanking panel - No FRU				
X6958A Disk Drive Blanking Module - No FRU				
X6943A PCI/QUAD FastEthernet card				
Rack Mounting Kit				
X6938A Chassis mount adapter, 19" rack - No FRU				
X6939A Chassis mount adapter, 23" rack - No FRU				
X6940A Chassis mount adapter, 24" rack - No FRU				
X6941A Chassis mount adapter, 600mm rack - No FRU				
Misc				
X6937A no FRU				
X6952A Chassis filters and PSU fileters no FRU				
FRU,ASSY,EJECTOR,CPU,FT1800	#540-4353	1	1	1
FRU,ASSY,EJECTOR,SMALL,ft1800	#540-3497	1	1	1
FRU,ASSY,EJECTOR,CAF,ft1800	#540-4300	1	1	1
FRU,ASSY,EJECTOR,PCI, ft1800	#540-4301	1	1	1

Spare parts for Netra 150

Configuration Overview

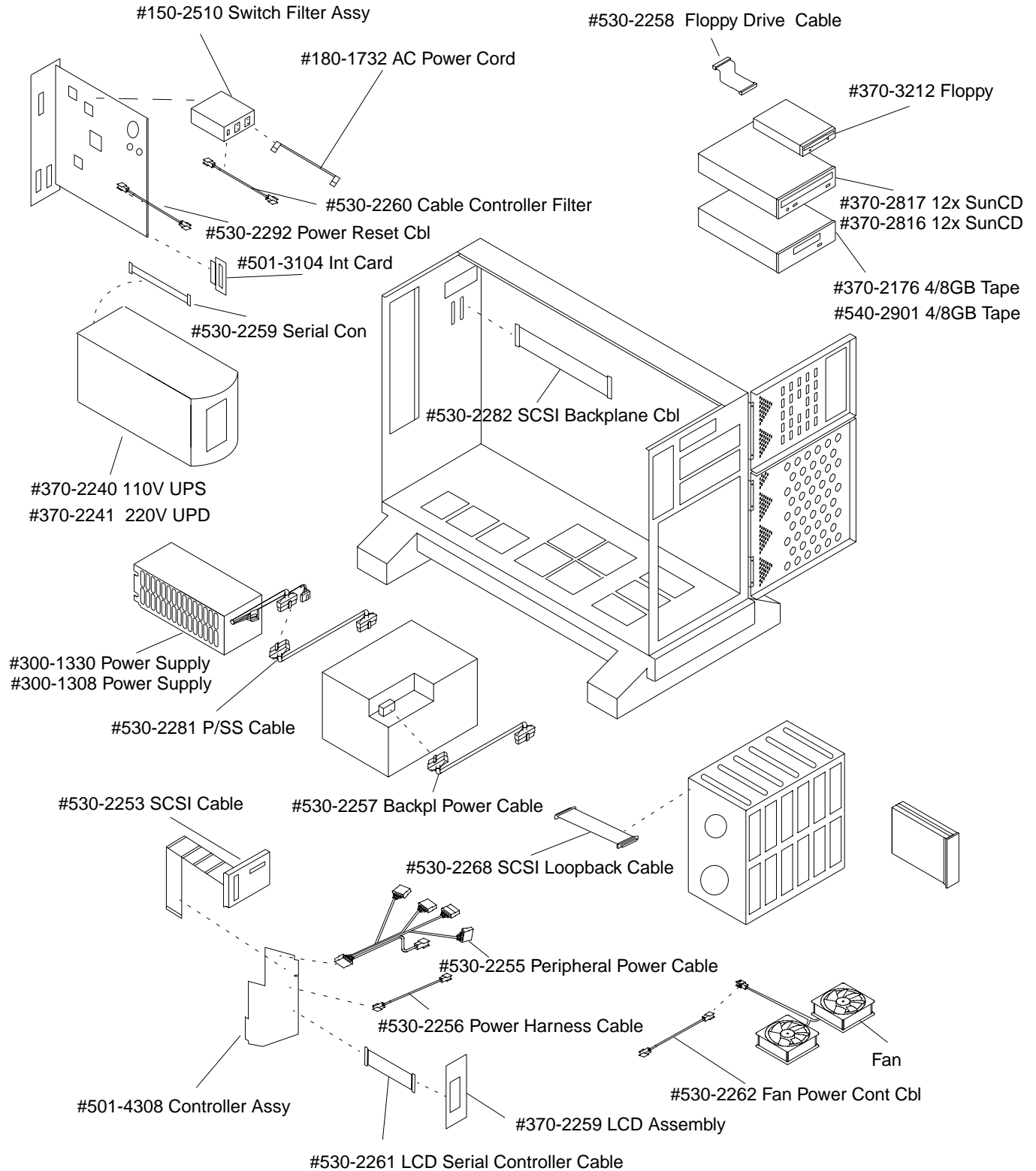

Spare parts for Netra 150 *(continued)*

Description	Order Number	Stocking Level		
		5	10	25
System Boards and Modules				
0MB ULTRA1 MODEL 170 SYSTEM BD	#501-3082	1	2	6
Memory and Mass Storage				
MEM,DSIMM,32MB,60NS,S20,S10	#501-2622	1	1	3
MEMORY,DSIMM,64MB,60NS,S10/S20	#501-2480	1	1	3
MEM,DSIMM,32MB,60NS,S20,S10	#501-2622	1	1	3
RFB 32MB SIMM, 60NS, S20	RFB501-2622	1	1	3
DRV,4/8GB DDS2-CR TAPE,LT GREY	#370-2375	1	1	2
3D FLOPPY DRIVE	#370-3212	1	2	2
12X CD-ROM, MEDIUM GRAY	#370-2817	1	1	1
12-24GB DDS3 TAPE,4mm MED GREY	#370-2376	1	1	1
12X CD-ROM LIGHT GREY	#370-2816	1	1	1
SUNFASTETHERNET/FAST-WIDE BRD	#501-2739	1	1	2
CDROM 12X, INT WITH BRACKET A2	#540-2901	1	1	2
2.1GB 7200RPM DISK DRIVE ASSY	#540-2936	1	1	3
4.2GB 7200RPM Disk Drive Assy	#540-2938	1	1	1
Console				
MONITOR, 19 INCH COLOR	#365-1380	1	1	1
TURBOGX GRAPHICS BOARD	#501-2922	1	1	3
Chassis, Cables and Accessories				
SWITCH FILTER ASSY, E150	#150-2510	1	1	1
AC POWER CORD, RIGHT ANGLE	#180-1732	1	1	1
SYSTEM CONTROLLER E150	#501-4308	1	1	1
SYS BRD/CONTROLLER BRD ADPTER	#501-3104	1	1	1
SYSTEM CONTROLLER E150	#501-4308	1	1	1
180W P/SS DC EXTENDER CABLE	#530-2281	1	1	1
110V UPS, E150	#370-2240	1	1	1
220-VOLT UPS POWER SUPPLY E150	#370-2241	1	1	1
LCD ASSEMBLY, E150	#370-2259	1	1	1
EXT DIFF SCSI CBL,68-PIN, 25CM	#530-2057	1	1	1
FLOPPY/SCSI, DATA CABLE, E150	#530-2253	1	1	1
PERIPHERAL DC WIRE HARNES E150	#530-2255	1	1	1
BCKPLN/CNTRLR DC WIRE HARNESS	#530-2256	1	1	1
185W PWR SUP/BCKPLN DC WRE HRN	#530-2257	1	1	1
FLOPPY DATA CABLE, 190MM E150	#530-2258	1	1	1
CONTROLLER FOR UPS CABLE E150	#530-2259	1	1	1
CABLE CNTRLR-AC FLTR/SWTCH	#530-2260	1	1	1
CONTROLLER TO LCD CABLE E150	#530-2261	1	1	1
FAN DC POWER CABLE E150	#530-2262	1	1	1
BKPLN SCSI LPBCK CBL, 194MM	#530-2268	1	1	1
INTRNL SCSI CABLE, 590MM E150	#530-2282	1	1	1
CNTRLR/SYS BD POWER RESET CABL	#530-2292	1	1	1
POWER SUPPLY, 185W E150	#300-1330	1	1	1
180W POWER SUPPLY E150 & ULTRA	#300-1308	1	1	1

Spare parts for Netra t1 Model 105 Network Server

Description	Order Number	Stocking Level		
		5	10	25
System Boards and Modules				
FRU,ASSY,GEN,360MHZ,NO DISK	#540-4317	1	2	6
FRU,ASSY,GEN,440MHZ,NO DISK	#540-4318	1	2	6
FRU,ASSY,GEN,440MHZ,512MB	#540-4424	1	2	6
FRU,ASSY,GEN,360MHZ,512MB,18GB	#540-4385	1	2	6
Memory and Mass Storage				
FRU,ASSY,CPCI,512B,MEMORY,	#540-4350	1	1	3
FRU,ASSY,CPCI,256MB,MEMORY,	#540-4349	1	1	3
FRU,NORDICA,64MB,MEMORY,	#540-4348	1	1	3
9.1GB 7200RPM Disk Drive Assy	#540-3704	1	1	3
FRU,Int Disk 18.2GB/10k USCSI	#540-4177	1	1	3
INT DISK 9.1GB/10K USCSI	#540-3881	1	1	3
125VAC POWER CORD,6FT US JAPAN	#180-1179	1	1	3
EMPTY TAPE/CD ENCLOSURE LT GRY	#595-3711	1	1	3
Chassis, Cables and Accessories				
FRU,ASSY,CD-ROM/CBL,	#540-4358	1	1	1
EXT68-PIN/68-PIN SCSI CBL,80mm	#530-1884	1	1	1
12X CD-ROM LIGHT GREY	#370-2816	1	1	1
2.5M POWER CORD, AUSTRALIA/NZ	#530-1822	1	1	1
AC POWER CORD, CONT. EUROPE	#530-1817	1	1	1
2.5M POWER CORD, DENMARK	#530-1819	1	1	1
2.5M POWER CORD, ITALIA	#530-1820	1	1	1
AC POWER CORD 115V US Sys-Mon	#180-1097	1	1	1
2.5M POWER CORD, SWISS	#530-1818	1	1	1
2.5M POWER CORD, UK	#530-1821	1	1	1

Spare parts for Netra xt 600 DC

Description	Order Number	Stocking Level		
		5	10	25
X997A				
ASSY, TOP OPT, VEGAS, DC	#595-5183	1	2	6
X996A				
ASSY, TOP OPT, VEGAS, DC	#595-5183	1	1	3

Spare parts for Netra t 1400/1405 Telco Server

Description	Order Number	Stocking Level		
		5	10	25
System Boards and Modules				
440MHz UltraSPARC-II/4MB each	#501-5682	1	2	6
FRU,ASSY, MOTHERBOARD	#501-5168	1	2	6
Memory and Mass Storage				
FRU,Int Disk 18.2GB/10k USCSI	#540-4177	1	1	3
ASSY,DSIMM,64MB,60NS,TSTD,	#501-5691	1	1	3
SIMM,256MB,60NS,E450	#501-4743	1	1	3
CDROM, 32X, SERVER MEDIUM GREY	#370-3416	1	1	3
Chassis, Cables and Accessories				
DC/DC CONVERTER,125 W,D122	#300-1407	1	1	1
FRU,PWR,SUPPLY,D129	#300-1435	1	1	1
FRU,ASY,RCP/ALARMS,NETRA-T	#501-5437	1	1	1
FRU,ASSY,FANS,CPU	#540-4262	1	1	1
FRU,ASSY,PDB/SUBFRAME	#370-3920	1	1	1
FRU,ASSY,PCB,SCSI ADAPTER	#501-5125	1	1	1
FRU,ASSY,LED PCB	#501-5560	1	1	1
FRU,ASSY,FAN CONTROL PCB	#501-5561	1	1	1
CABLE, POWER SWITCH, TS-1100	#530-2514	1	1	1
FRU,ASSY,HDD BAY	#540-4311	1	1	1
FRU,ASSY,FAN,120MM	#370-3976	1	1	1